



Alma Row, Whiston



Guide Price £240,000 to £250,000 - This OUTSTANDING two bedroom stone built cottage sits nestled in the heart of Whiston Village, a much sought after location providing great commuter transport links and with popular pubs and restaurants all on the doorstep. It is beautifully presented, well maintained and appointed with a high specification throughout with pleasant outdoor patio seating areas enjoying tree lined elevated views. Accommodation comprises: Hall, Lounge with feature fireplace, stylish Kitchen Diner with integral appliances and a Belfast sink, two double Bedrooms, Bathroom suite with a roll top bath and separate shower cubicle. Outdoor space is at a premium within the village so you will be thrilled with the privately enclosed split level patio seating areas, the lower with a built-in BBQ, the upper with further bedding areas and a view! VIEWING STRONGLY ADVISED - By Appointment Only.



- **OUTSTANDING Two Bedroom Stone-Built Cottage**
- **In-Demand Whiston Village Location with Popular Pubs and Restaurants Close By**
- **Beautifully Present and Appointed with a HIGH SPECIFICATION Throughout**
- **Fabulous Outdoor Split-Level Patio Seating Space with a View!**
- **Lounge with Feature Fireplace, Stylish Kitchen Diner with Integral Appliances and Belfast Sink**
- **Contemporary Bathroom Suite with Roll Top Bath and Shower Cubicle**
- **** Viewing Strongly Advised ** EPC: To Follow**

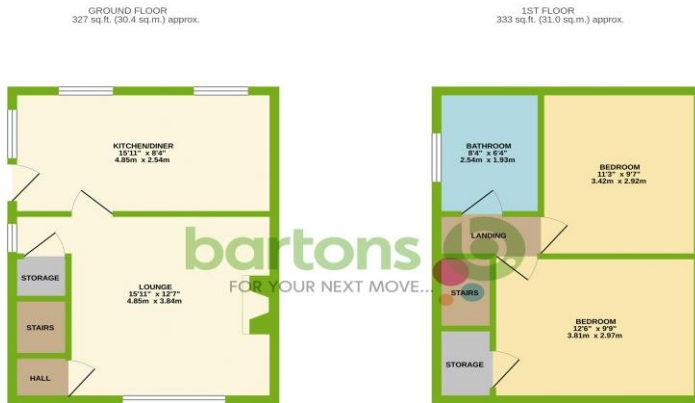

bartons **b.**
FOR YOUR NEXT MOVE...

51-53 Moorgate Street, Rotherham, South Yorkshire, S60 2EY
T: 01709 515740 E: info@bartons-net.co.uk

Important Notice These particulars are issued in good faith but do not constitute representations of fact or form part of any contract. These particulars should be independently verified by prospective buyers or tenants. Neither Barton Real Estates Ltd nor any of its employees or agents has any authority to make or give any representation or warranty whatsoever in relation to this property. Any areas of measurement or distances are approximate. Please note that we have not tested the services or any of the equipment in this property, accordingly we strongly advise prospective buyers to commission their own survey or service reports before finalising their offer to purchase. Printed by Faceforward on 16/07/2023. 713330